

# SM Series - SIMM Sockets

1,27mm pitch



SIMM sockets are made of hi-temp resistant LCP.

Single row types are available in vertical and slanted version ( 26°).

Insertion & extraction of the module can be made without any tools.

Positive polarization prevents wrong insertion of the module.

Contacts are designed with an anti-overstress feature.



## Single row - vertical

Standard Type

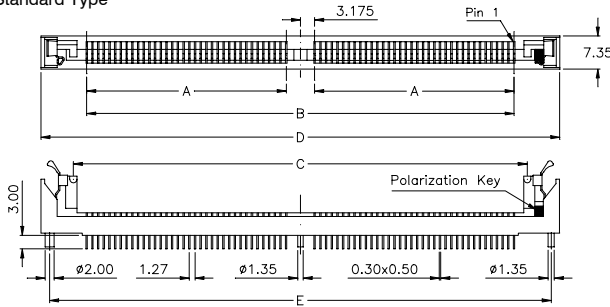

PCB hole layout

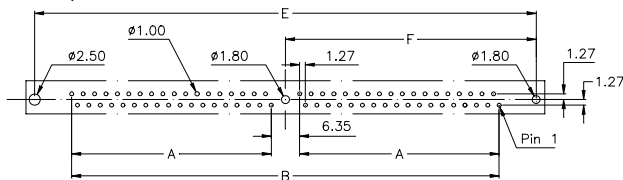

Reverse Type

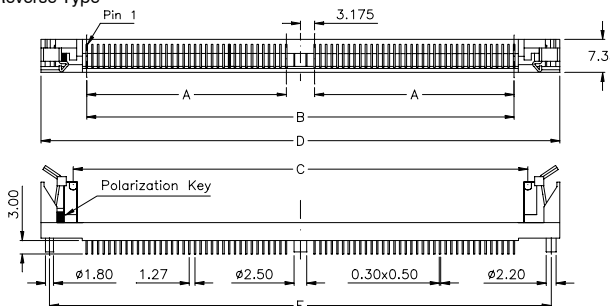

PCB hole layout

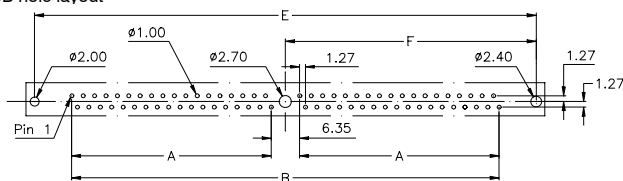

## Single row - 26° slanted

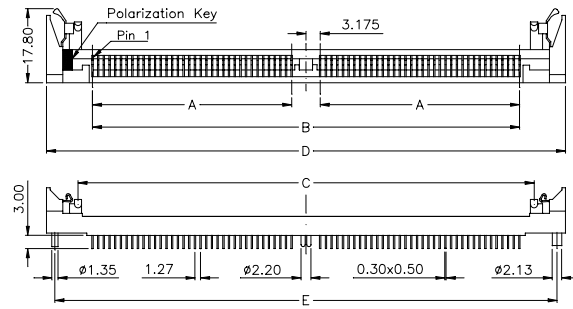

PCB hole layout

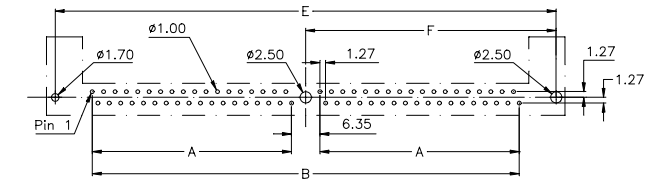

## Specifications

Current rating	: 1 A max., 100V
Contact resistance	: 30 mΩ max.
Breakdown voltage	: 1,5 k V RMS max.
Insulation resistance	: 10 <sup>4</sup> MΩ min.
Capacitance	: 2 pF max.
Contact force	: 2 N min. (Module: 1.19 mm to 1.37mm thick)
Operating temperature	: -55 °C to + 150 °C min.
Insulator (RoHS compliant)	: high temp plastic (ivory) UL 94 V-0
Contact (RoHS compliant)	: Phosphor bronze
Plating	: Sn (leadfree) over Ni

## Dimensions for 1,27mm pitch SIMM Modules

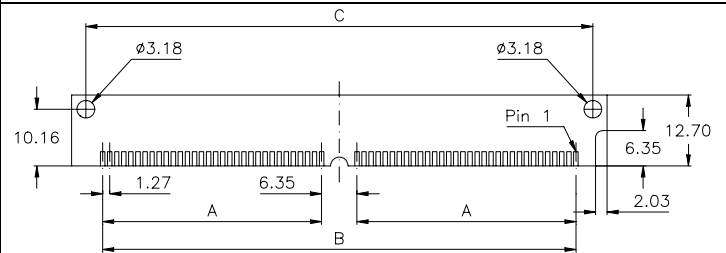

Pin	Execution	Ordering Code		Dimensions mm					
		Standard Type	Reverse Type	"A"	"B"	"C"	"D"	"E"	"F"
72	vertical	<b>SM1 - 072 - TV99 - 99 / 1M</b>	<b>SM1 - 072 - TV99 - 99 / 1MR</b>	44,45	95,25	101,20	115,50	111,76	55,88
80	vertical	<b>SM1 - 080 - TV99 - 99 / 1M</b>	<b>SM1 - 080 - TV99 - 99 / 1MR</b>	49,53	105,40	111,30	125,60	121,60	60,80
72	26° slanted	<b>SM1 - 072 - TS99 - 99 / 1M</b>		44,45	95,25	101,20	115,50	111,76	55,88
80	26° slanted	<b>SM1 - 080 - TS99 - 99 / 1M</b>		49,53	105,40	111,30	125,60	121,60	60,80