

female

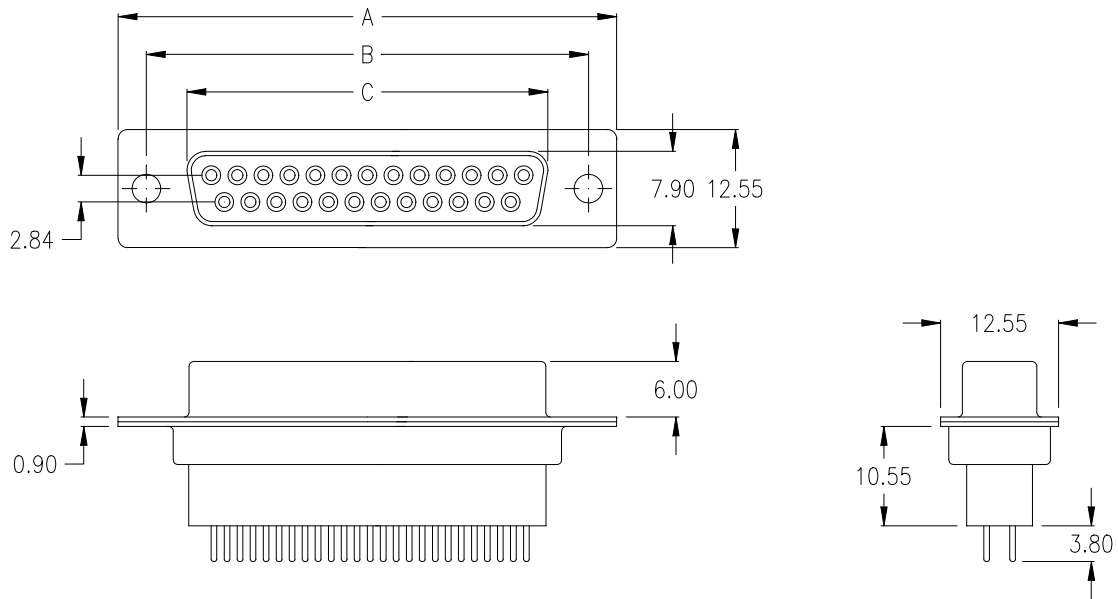

Ordering Code

SDF - xxx - B111 - 95 / XXX

No. of contacts

Option

Plating: -95 = tin(leadfree)/gold

General Specification page 72

| No. of contacts | Dimension | | |
|-----------------|-----------------------|-----------------------|-----------------------|
| | A | B | C |
| 009 | <u>30.81</u> 1.213 | <u>24.99</u> .984 | <u>16.33</u> .643 |
| 015 | <u>39.14</u> 1.541 | <u>33.32</u> 1.312 | <u>24.66</u> .971 |
| 025 | <u>53.04</u> 2.088 | <u>47.04</u> 1.852 | <u>38.38</u> 1.511 |
| 037 | <u>69.32</u> 2.729 | <u>63.50</u> 2.500 | <u>54.84</u> 2.159 |

Options

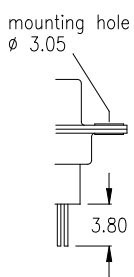

T0

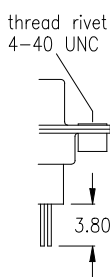

T

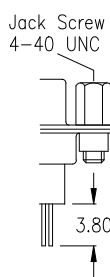

TJ

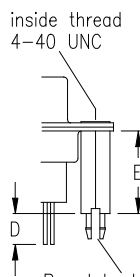

BR

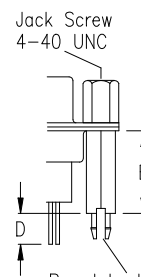

BRJ

| D ±0.20 | E | Option |
|---------|-------|----------|
| 3,20 | 12,70 | 1 |
| 3,50 | 11,00 | 2 |
| 3,20 | 14,50 | 4 |
| 4,20 | 13,50 | 5 |

PCB Layout „female“

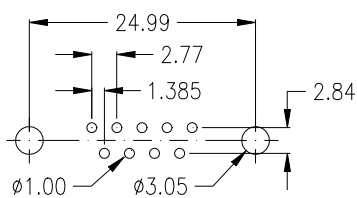

9 pin

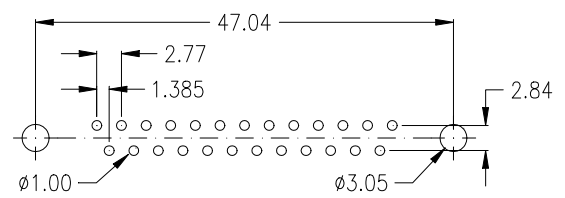

25 pin

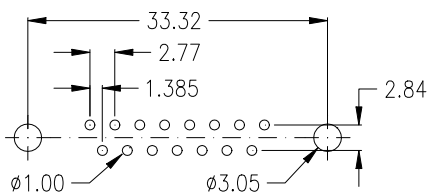

15 pin

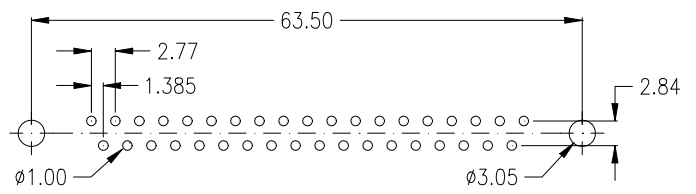

37 pin

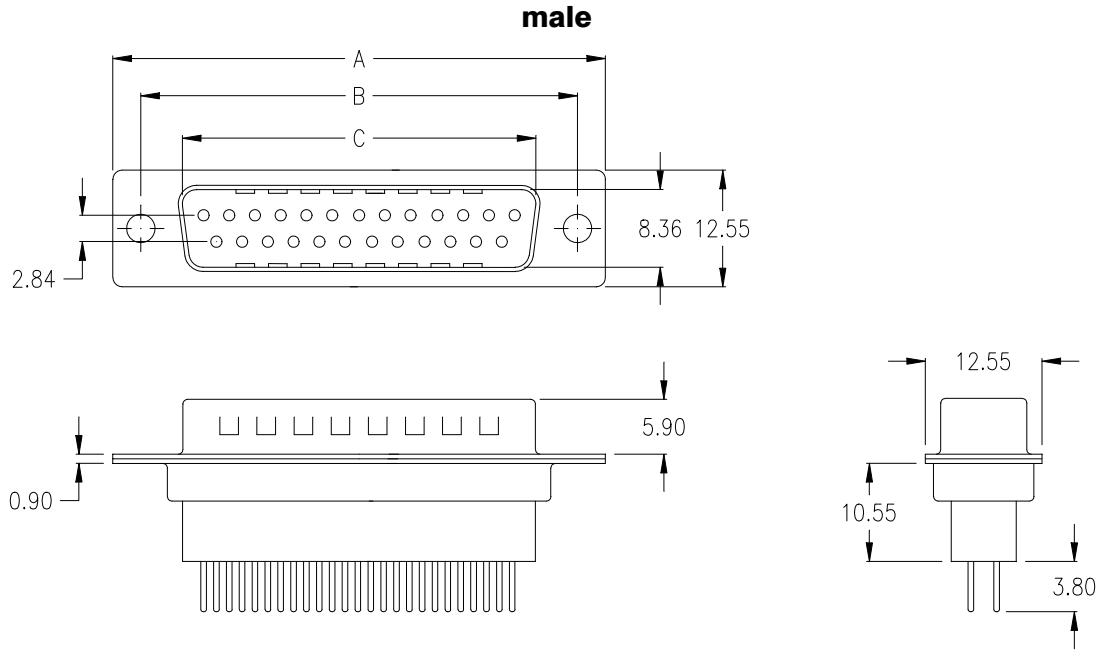

Ordering Code

SDM - xxx - B111 - 95 / XXX

No. of contacts

Option

Plating: -95 = tin(leadfree)/gold

General Specification page 72

| No. of contacts | Dimension | | |
|-----------------|----------------|----------------|----------------|
| | A | B | C |
| 009 | 30.81 1.213 | 24.99 .984 | 16.92 .666 |
| 015 | 39.14 1.541 | 33.32 1.312 | 25.25 .994 |
| 025 | 53.04 2.088 | 47.04 1.852 | 38.96 1.534 |
| 037 | 69.32 2.729 | 63.50 2.500 | 55.42 2.182 |

Options

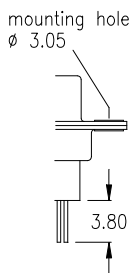

T0

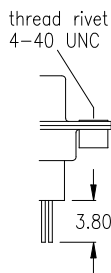

T

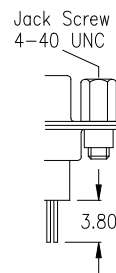

TJ

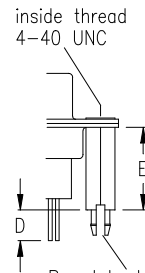

BR

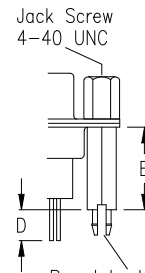

BRJ

| D ±0.20 | E | Option |
|---------|-------|----------|
| 3,20 | 12,70 | 1 |
| 3,50 | 11,00 | 2 |
| 3,20 | 14,50 | 4 |
| 4,20 | 13,50 | 5 |

PCB Layout „male“

9 pin

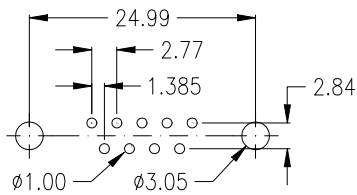

25 pin

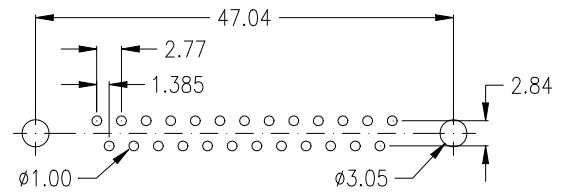

15 pin

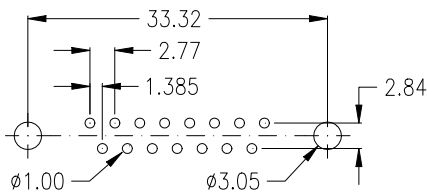

37 pin

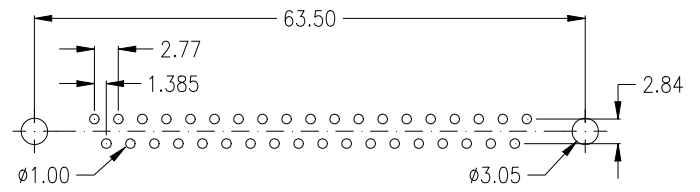



mechanical data

| | |
|---|---------------------------------|
| Mating force per contact | ≤ 3,4 N |
| Unmating force per contact | ≥ 0,2 N |
| Temperature range | -55° C to +105° C |
| Processing temperature wave solder (solder bath) | +250°C +0/-5°C for 10sec. |
| Processing temperature SMT and "pin in paste" | +250°C +0/-5°C for 20~40sec. |
| Moisture absorption from air 50% rh | 0,10% |
| IDC Connector types accept AWG 26 or AWG 28 standard wire | |

materials and plating (RoHS compliant)

| | |
|---|---|
| Insulator for wave solder technology, standard black - PC 99 colourful insulator | thermoplastic glassfilled UL 94V – 0 Yellowish brown - Pantone # 131C 15-pos. female Burgundy - Pantone # 235C 25-pos. female Teal - Pantone # 322C 9-pos. male Blue - Pantone # 661C HD 15-pos. female |
| Insulator for SMT and "Pin-In-Paste" | Nylon UL 94V-0 |
| Shell | Steel, Ni plated |
| Bracket | Brass, tin plated |
| Male contact - plating | Copper Alloy (Standard; others on request) -95 = solder side Sn; contact side Au over Ni -55 = solder and contact side Au over Ni |
| Female contact - plating | Copper Alloy (Standard; others on request) -95 = solder side Sn; contact side Au over Ni -55 = solder and contact side Au over Ni |
| D-Sub Accessories (page 70) plating | -NN = Ni |

electrical data

| | |
|---|--|
| max. Current rating | 5 A/25°C 3 A/70°C (High Density types 3A / IDC types 1A) |
| Operating voltage | 250 V |
| Test voltage between contacts | 1000 V / 50/60 Hz / 1 Minute |
| Test voltage between shell and contacts | 1000 V / 50/60 Hz / 1 Minute |
| Resistance between mated contacts | < 30 m Ω |
| Insulation resistance | ≥ 1000 M Ω at 500V DC |
| Dielectric strength | 1000 V AC min. for 1 Minute |
| Volume resistivity | 10 ¹⁶ Ω cm (ASTM-D 257) |

available performance classes

E-tec D-Sub connectors comply with Performance Class 3 (min. 50 contact cycles).

Please contact E-tec first for availability of Performance Class 2 (min. 200 contact cycles) and 1 (min. 500 contact cycles)

D-Sub with Filter (ferrite)

| | |
|-----------------|----------------|
| Frequency range | 10 - 300 MHz |
| Impedance | 5 MHz - 15 Ω |
| | 25 MHz - 30 Ω |
| | 100 MHz - 50 Ω |
| | 300 MHz - 75 Ω |

