

**9-pin male raised**

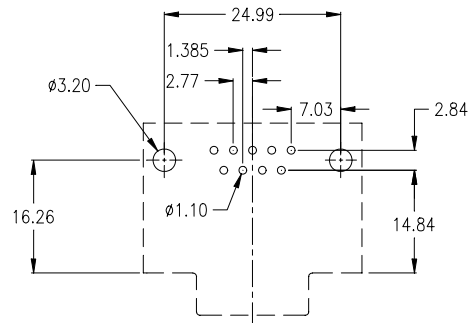

PCB hole layout

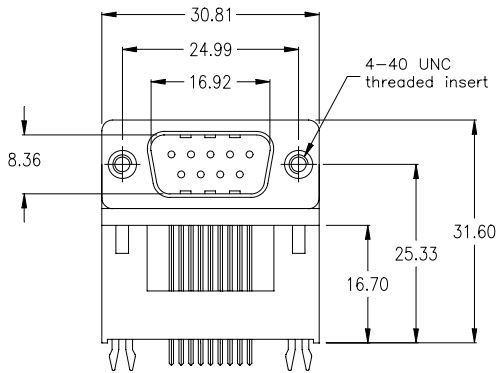
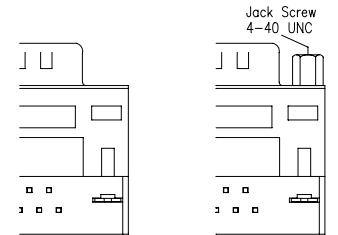
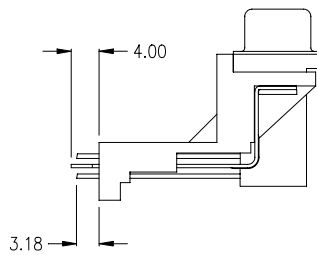
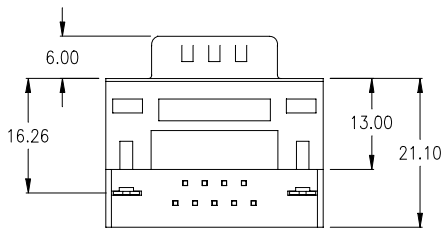

Style "-MN"

Style "-MNJ"

with 2 grounding clips;  
w/o jack screws  
*Standard*  
( as above drawing )

with 2 grounding clips;  
2 jack screws 4-40 UNC  
mounted  
*Option*

SDD-0900-2-95-MN

SDD-0900-2-95-MNJ

**9-pin female raised**

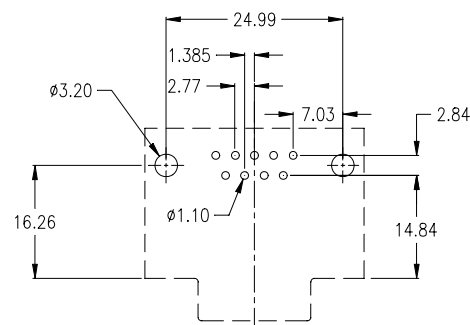
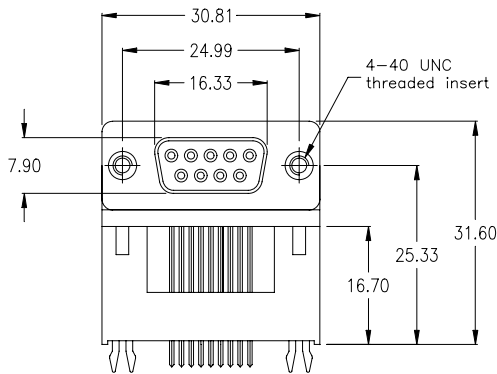

PCB hole layout

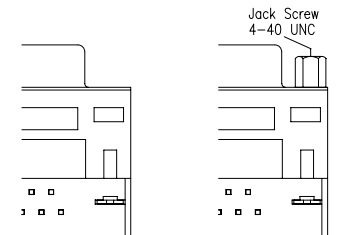
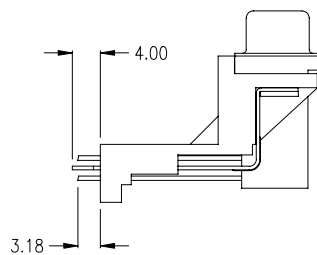
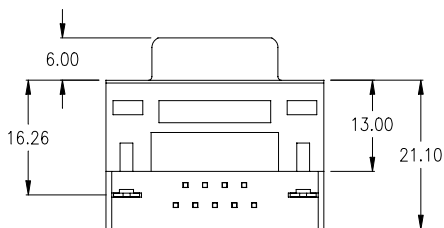

Style "-FN"

Style "-FNJ"

with 2 grounding clips;  
w/o jack screws  
*Standard*  
( as above drawing )

with 2 grounding clips;  
2 jack screws 4-40 UNC  
mounted  
*Option*

SDD-0900-2-95-FN

SDD-0900-2-95-FNJ



## mechanical data

|   |                                 |
|---|---------------------------------|
| Mating force per contact                                  | ≤ 3,4 N                         |
| Unmating force per contact                                | ≥ 0,2 N                         |
| Temperature range   | -55° C to +105° C               |
| Processing temperature wave solder (solder bath)          | +250°C +0/-5°C<br>for 10sec.    |
| Processing temperature SMT and "pin in paste"             | +250°C +0/-5°C<br>for 20~40sec. |
| Moisture absorption from air 50% rh                       | 0,10%                           |
| IDC Connector types accept AWG 26 or AWG 28 standard wire |                                 |

## materials and plating (RoHS compliant)

|   |   |
|---|---|
| Insulator for wave solder technology, standard black<br>- PC 99 colourful insulator | thermoplastic glassfilled UL 94V – 0<br>Yellowish brown - Pantone # 131C 15-pos. female<br>Burgundy - Pantone # 235C 25-pos. female<br>Teal - Pantone # 322C 9-pos. male<br>Blue - Pantone # 661C HD 15-pos. female |
| Insulator for SMT and "Pin-In-Paste"  | Nylon UL 94V-0  |
| Shell   | Steel, Ni plated  |
| Bracket   | Brass, tin plated   |
| Male contact<br>- plating   | Copper Alloy (Standard; others on request)<br><b>-95</b> = solder side Sn; contact side Au over Ni<br><b>-55</b> = solder and contact side Au over Ni   |
| Female contact<br>- plating   | Copper Alloy (Standard; others on request)<br><b>-95</b> = solder side Sn; contact side Au over Ni<br><b>-55</b> = solder and contact side Au over Ni   |
| D-Sub Accessories (page 70) plating   | <b>-NN</b> = Ni   |

## electrical data

|   |  |
|---|--|
| max. Current rating                     | 5 A/25°C 3 A/70°C (High Density types 3A / IDC types 1A) |
| Operating voltage                       | 250 V  |
| Test voltage between contacts           | 1000 V / 50/60 Hz / 1 Minute                             |
| Test voltage between shell and contacts | 1000 V / 50/60 Hz / 1 Minute                             |
| Resistance between mated contacts       | < 30 m Ω   |
| Insulation resistance                   | ≥ 1000 M Ω at 500V DC                                    |
| Dielectric strength                     | 1000 V AC min. for 1 Minute                              |
| Volume resistivity                      | 10 <sup>16</sup> Ω cm (ASTM-D 257 )                      |

## available performance classes

E-tec D-Sub connectors comply with Performance Class 3 (min. 50 contact cycles).

Please contact E-tec first for availability of Performance Class 2 (min. 200 contact cycles) and 1 (min. 500 contact cycles)

## D-Sub with Filter ( ferrite )

|                 |                |
|-----------------|----------------|
| Frequency range | 10 - 300 MHz   |
| Impedance       | 5 MHz - 15 Ω   |
|                 | 25 MHz - 30 Ω  |
|                 | 100 MHz - 50 Ω |
|                 | 300 MHz - 75 Ω |

