

2.00mm pitch

- SMT - Pin Header & Board Spacer

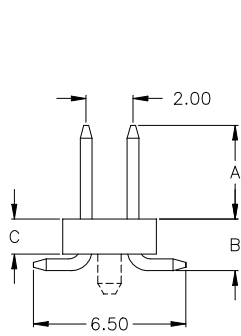

SS2 Type

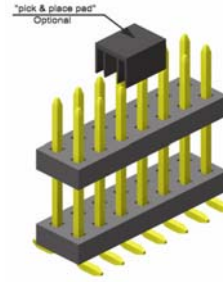
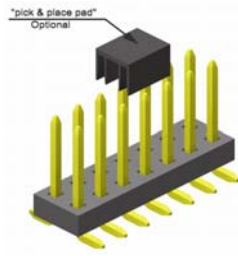
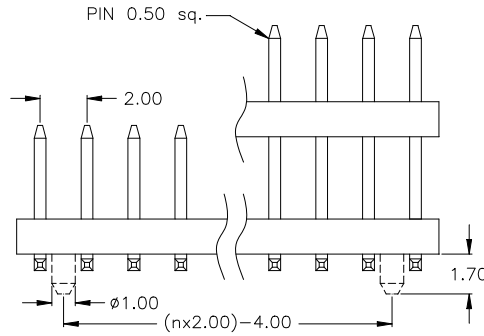

SP2 Type

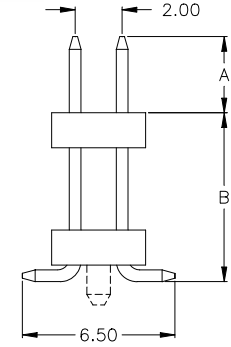

APPLICATION AND FEATURES

- **Standard: tube packing, without "locating pegs" and "pick & place pad"**
- Designed for "board to board" spacing
- Variable terminal length available
- Mate with female header 2,00 mm x 2,00 mm pitch

PCB Surface Mount Layout

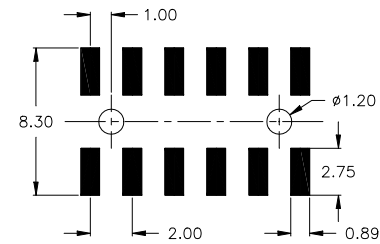

SPECIFICATIONS

Current rating	1 A
Insulator resistance	5000 MΩ min.
Contact resistance	20 mΩ max.
Dielectric withstanding voltage	500 V AC

Operating temperature	- 40°C to +105°C
Processing temperature	+250°C +0/-5°C
	SS2 Type = 250°C for 20 sec.
	SP2 Type = 250°C for 5 sec.
Contact material	(RoHS compliant) Copper alloy
Insulator material	(RoHS compliant) Nylon UL 94 V-0

How to order

S X 2 - xxx - H xxx/x - 55 /2 X

Type	Nbr of contacts	Terminal style				Plating	Packing and "pick & place pad" Option	
		Type	Code	DIM A	DIM B			DIM C
S Low Profile	006	S	064/0	6.00mm	2.20mm	1.50mm	gold	without "locating pegs" A = tube packing; with pick & place pad B = reel packing; with pick & place pad
			064/1	4.00mm	2.20mm	1.50mm		
			064/2	3.50mm	2.70mm	2.00mm		
			064/3	5.80mm	2.20mm	1.50mm		
			064/4	3.20mm	2.20mm	1.50mm		
			064/5	3.60mm	2.20mm	1.50mm		
			064/6	4.00mm	2.70mm	2.00mm		
			064/7	8.00mm	2.20mm	1.50mm		
	064/8	10.00mm	2.20mm	1.50mm	with "locating pegs" (if DIM "C" = 1.50mm only) C = tube packing; without pick & place pad D = tube packing; with pick & place pad E = reel packing; with pick & place pad			
	P	065/0	6.00mm	6.00mm				
		065/1	6.00mm	10.00mm				
		065/2	6.00mm	12.00mm				
		065/3	4.00mm	13.33mm				
		065/4	3.90mm	8.00mm				
		065/5	4.50mm	17.00mm				
		065/6	9.50mm	12.00mm				
065/7		7.50mm	8.50mm					
065/8	4.65mm	12.70mm						
065/9	5.00mm	12.30mm						
065/A	5.40mm	7.00mm						
065/B	4.50mm	16.00mm						
Other dimensions on request								